

● Standard Dimensions

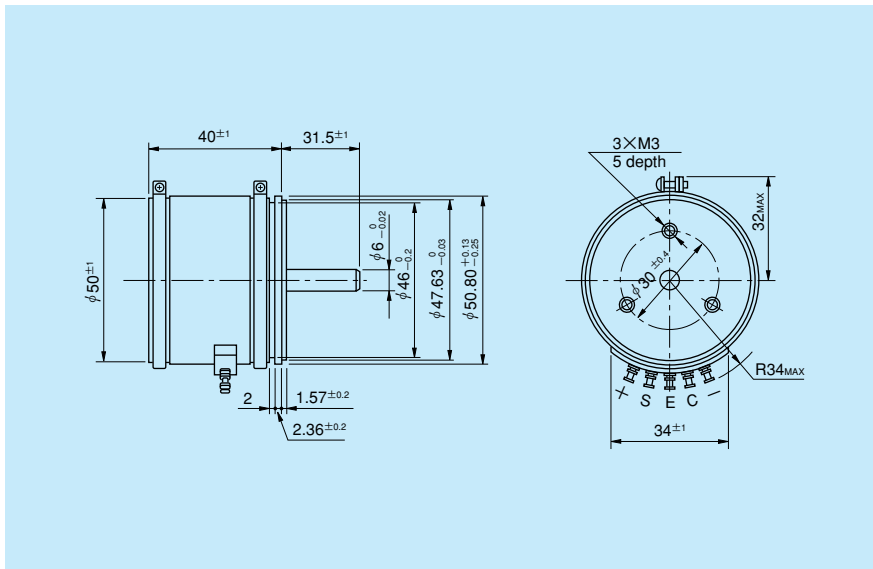
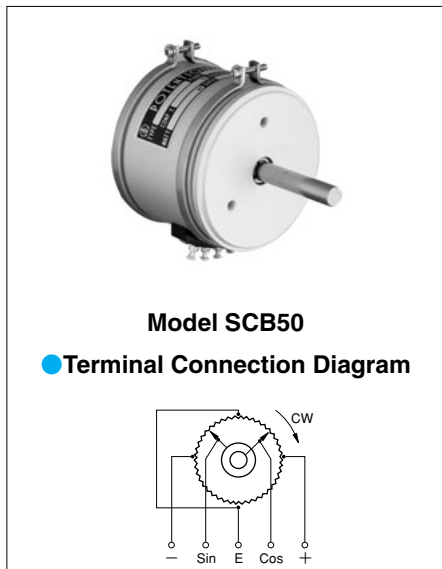

● General Specifications

Standard Resistance

Range: 500Ω to 10kΩ

Max. Practical

Resistance Value: 20kΩ

Total Resistance

Tolerance: Standard Class ±5% (J)

Precision Class ±3% (H)

Conformity

Tolerance: Standard Class ±1.0%

(Peak-Peak) Precision Class ±0.5% (Over 5kΩ)

±0.7% (Within 5kΩ)

Power Rating: 2.0W

Noise: Within 100Ω E.N.R.

Electrical Travel: 360° (Endless)

Mechanical Travel: 360° (Endless)

Insulation Resistance: Over 1,000MΩ at 1,000V.D.C.

Dielectric Strength: 1 minute at 1,000V.A.C.

Starting Torque: Within 11mN·m (110gf·cm)

Max. Working Voltage: 250V

Resist. Temperature

Coefficient of Wire: ±20p.p.m./°C

Mass: Approx. 160g

● Standard Resistance Values ■ No. of Wire Turns ■ Resistance Wire Used

Resist. Value (Ω)	500	1k	2k	5k	10k	※20k
No. of Wire Turns	1,000	1,400	1,800	1,800	2,000	2,500
Resist. Wire Used	Cu-Ni System			Ni-Cr System		

Note: Mark ※shows value at special higher practical resistance.

● Special Specifications Available

Multi-ganged (Available up to 3 gangs. Housing length is extended by 30mm per 1 gang), Rear shaft (6mm dia. and 15mm length), Bushingmount type, Inch dimensional shaft dia. (φ 6.35mm), Special machining on the shaft, Oil-filled type.